

Storm Doors



Lifetime Storm Doors

The Harvey Lifetime Storm Door offers greater insulating power and convenience than ever before. A heavy-duty solid wood core wrapped in a seamless vinyl or aluminum skin provides superior insulation while resisting dents. A hinge system made up of five independent Oilite Bearings provides extra durability.



The solid wood core in the Lifetime Storm Door features a lifetime warranty



Glass inserts with heavy-duty wool pile weatherstripping keep winter winds out while heat and warmth are sealed inside.

We have eliminated exposed screws or other fasteners to give each Lifetime Storm Door a more finished appearance.

Optional exterior brasstone lever with deadbolt or brasstone door sweep for added elegance





Actual colors may vary.



Easy release finger latches allow for quick seasonal changes of screens and glass panels



Choose the timeless beauty of beveled glass for an upscale look



Deluxe hardware with deadbolt and heavy-duty knob set are optional



Panorama*



Full-Lite



Classic



Crossbuck



Victorian



Duo-Provincial



Lexington



One-Lite



Self Storing

Lifetime Storm Doors available in white vinyl or bronze aluminum.

*Panorama style available in 32" x 80" and 36" x 80" style only.

Heavy Duty Stainless Steel Screen Option

Designed to be a permanent fixture, the heavy-duty black powder coated stainless steel screen is installed as a preassembled unit. A 90 degree bend along the screen's edges locks it firmly into the solid core door frame. (Glass inserts may be added or removed, but the screen always remains fixed.)

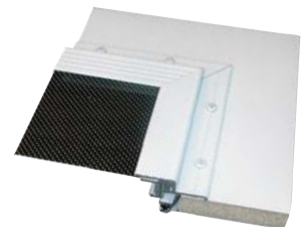

Storm Doors



Traditional Storm Doors

The Harvey Traditional Storm Door has been designed to suit your style. Each door comes with both a glass and a screen insert. The glass insert has wool pile weatherstripping to provide extra protection against drafts. For greater durability, electrostatically-applied enamel paint is baked to a hard, tough finish, and an adjustable bottom expander with dual weatherstripping ensures a snug fit to your door's threshold.



Super strength extruded corners guaranteed against breaking or sagging



Harvey Traditional Storm Door features:

- Full-length piano hinge is pre-lubricated and anodized for long trouble-free service
- Door frame is constructed of heavy-duty tubular extrusions
- Super strength extruded corners are guaranteed against breaking or sagging
- Seasonal changes from glass to screen are easily accomplished with thumb screws and clips
- Adjustable bottom expander has dual weatherstripping to ensure a snug fit to the threshold

*See actual warranty for details.

